

# Sentinel Connector Systems Inc.

1953 Stanton Street  
York, Pa. 17404

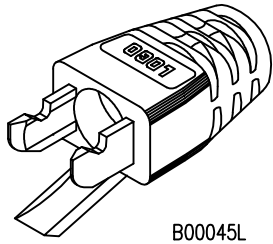

B00045L  
STYLE

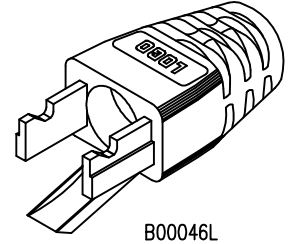

B00046L  
STYLE

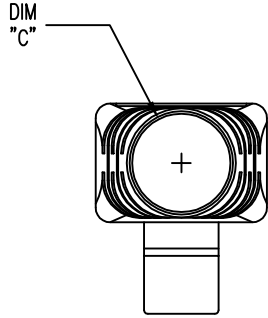

DIM  
"C"

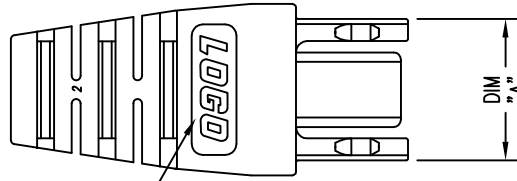

DIM  
"A"

LOGO

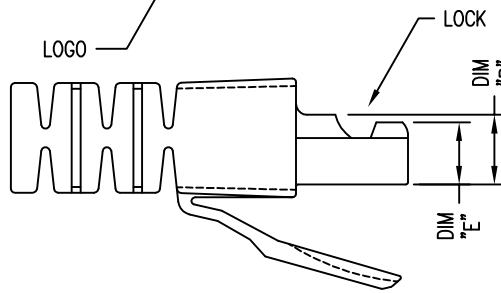

DIM  
"B"

DIM  
"E"

LOCK

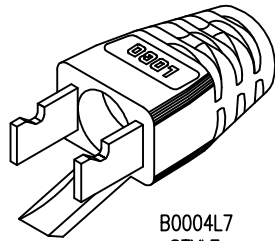
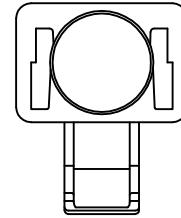

B00047L  
STYLE

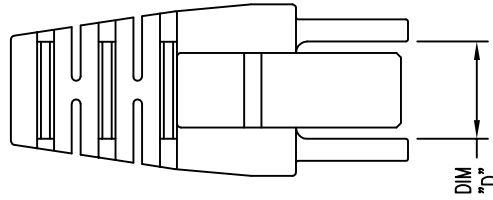

DIM  
"D"

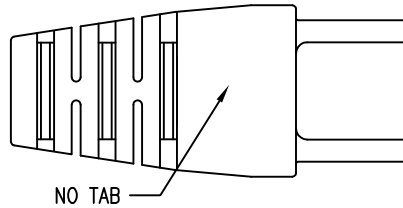

NO TAB

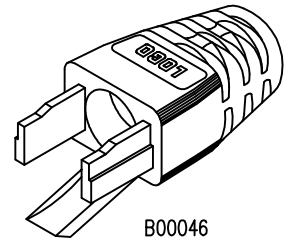

B00046  
STYLE

| PART NO.: | DIM "A" | DIM "B" | DIM "C" | TAB | LOGO TOP | LOCK | SAME AS, EXCEPT  | SHLD/UN  | DESIGN FOR   |
|-----------|---------|---------|---------|-----|----------|------|------------------|----------|--------------|
| B00044L   | .390    | .187    | 6.7mm   |     | LEVITON  | YES  | B00046L          | UNSHLD   | 111 LOAD BAR |
| B00044L2  | .390    | .187    | 6.0mm   |     | LEVITON  | YES  | B00046L          | UNSHLD   | 111 LOAD BAR |
| B00045L   | .320    | .190    | 6.7mm   |     | SENTINEL | YES  | AS DESIGNED      | UNSHLD   | 106 (5E)     |
| B00046    | .390    | .187    | 6.7mm   |     | SENTINEL | NO   | AS DESIGNED      | UNSHLD   | 111 LOAD BAR |
| B00046S   | .390    | .187    | 6.7mm   |     | SENTINEL | NO   | B00046           | SHIELDED | 111 LOAD BAR |
| B00046L   | .390    | .187    | 6.7mm   |     | SENTINEL | YES  | AS DESIGNED      | UNSHLD   | 111 LOAD BAR |
| B00047L   | .320    | .155    | 6.7mm   |     | SENTINEL | YES  | AS DESIGNED      | UNSHLD   | 110 (RAD BK) |
| B00049L   | .390    | .187    | 6.7mm   |     | NONE     | YES  | B00046L          | UNSHLD   | 111 LOAD BAR |
| B00055L   | .390    | .187    | 6.7mm   |     | SENTINEL | YES  | AS DESIGNED(46L) | UNSHLD   | 111 LOAD BAR |
| B00056L   | .390    | .187    | 6.7mm   |     | NONE     | YES  | B00055L          | UNSHLD   | 111 LOAD BAR |
| B00060S   | .390    | .187    | 6.7mm   |     | OCC      | NO   | B00046S          | SHIELDED | 111 LOAD BAR |
| B00060L   | .390    | .187    | 6.7mm   |     | OCC      | YES  | B00046L          | UNSHLD   | 111 LOAD BAR |
| B00061L2  | .390    | .187    | 6.0mm   |     | TYCO/NO  | YES  | B00044L2         | UNSHLD   | 111 LOAD BAR |

